

Cyclone

Cyclone 1

DIMENSIONS ARE IN MM									
SR.NO	A	B	C	D	E	ØF	G	ØH	ØI
C1	785	283	254	312	9	80	156	250	274

MATERIAL - WEAR RESISTANT Ni-HARD CASTING WITH
Min 500 BHN HARDNESS

Cyclone 2

DIMENSIONS ARE IN MM									
SR.NO	A	B	C	D	E	F	G	H	I
C2	800	300	280	12	8	122	260	90	R75

MATERIAL - IS 210 Gr FG 220 TO 260 WITH Cr

Cyclone 3

DIMENSIONS ARE IN MM									
Size	A	ØB	ØC	ØD	E	ØF	G	H	ØI
C3	798	276	280	398	9	106	315	330	25

MATERIAL - IS 3355 Gr 2A

Cyclone 4

DIMENSIONS ARE IN MM									
Size	A	ØB	ØC	ØD	E	ØF	G	H	ØI
C4	900	268	268	370	8	100	280	330	16

MATERIAL - IS 210 Gr. FG 220 WITH Cr



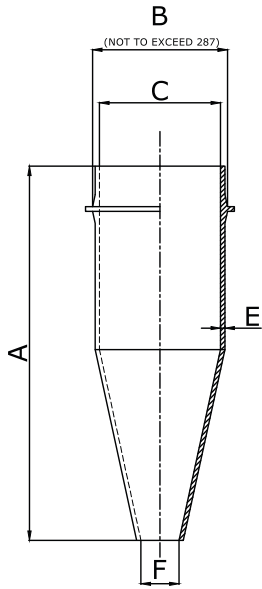

Cyclone 1

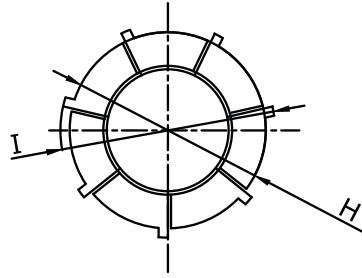

SPINNER

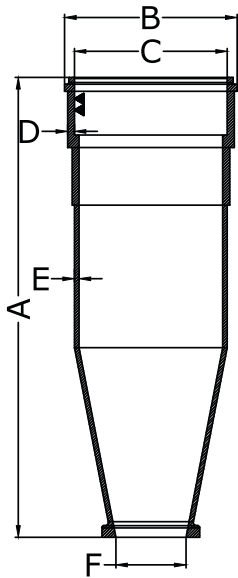
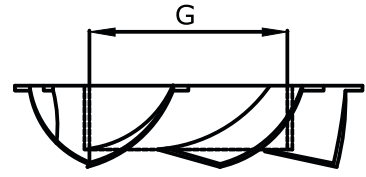

Cyclone 2

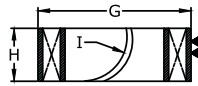

CYCLONE RH

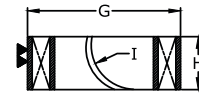

CYCLONE LH

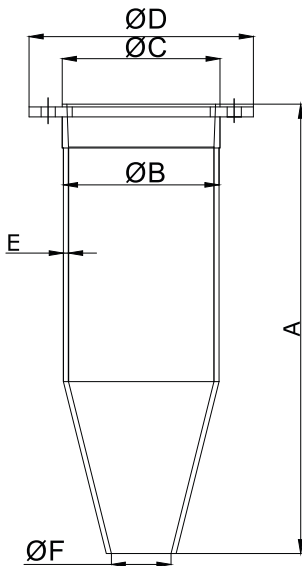
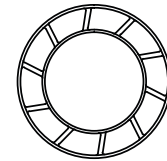
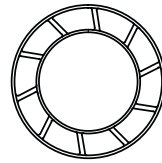

Cyclone 3 & 4

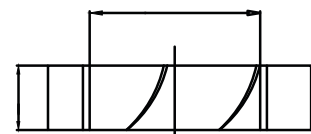
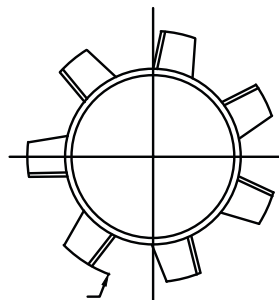

VANE